

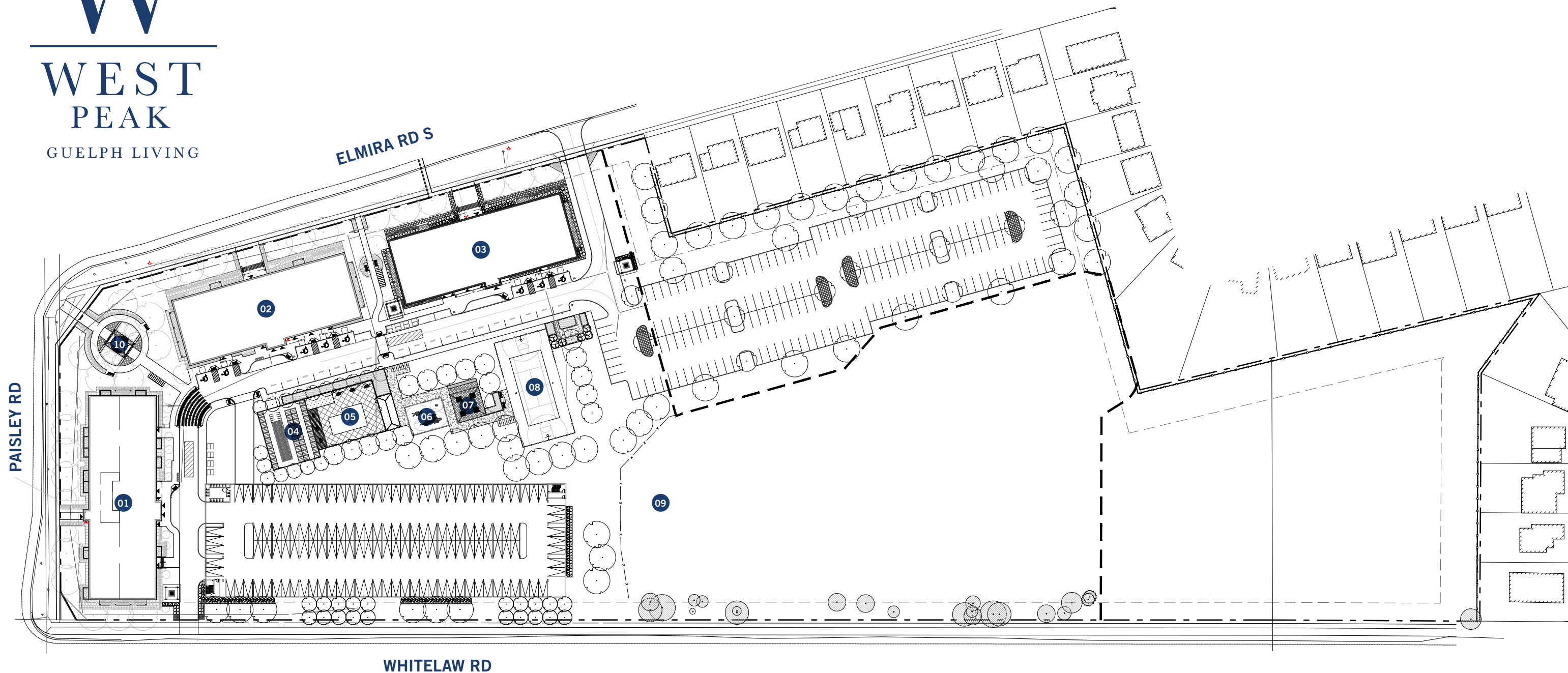

WEST PEAK

GUELPH LIVING



- | | | |
|----------------------|-------------------------|---|
| 01 Building A | 04 Bike Storage | 08 Multi-use Sport Court |
| 02 Building B | 05 Pool 6m x 12m | 09 Forested Area with
Walking & Bike Trails |
| 03 Building C | 06 Tot Lot | 10 Courtyard Seating |
| | 07 BBQ Area | |

Nothing feels better than coming home to the place you love. Take a dip in the pool, grill up your favourites with some friends in the BBQ area, get active at the multi-use sport court or stroll through the scenic walking trails. At the end of the day, take in the views on your private rooftop terrace, and enjoy. This is peak living.

